

1/8" O.D. Copper Tubing

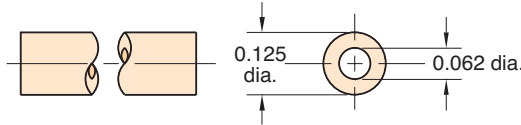
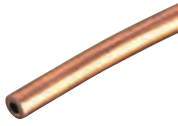

Part No. 3811-1-RL
Description Copper Tubing

Material: High pressure copper

Working Pressures: to 2,500 psig

Static Burst Pressure: over 10,000 psig

Lengths Available: 50'

Bend Radius: 3/8"

Use With: Ferrule tubing connectors: [3810-1](#), [3810-2](#), [11923](#)

3/32" I.D. Nylon Tubing

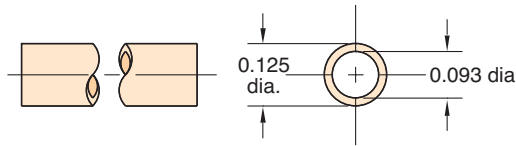

Part No. NYT1-0403-CLT-□

Material: Semi-flexible nylon tubing

Color: Clear / Translucent

Working Range: to 250 psig

Static Burst Pressure: Approx. 1,000 psig

Use With: Ferrule tubing connectors: [11923](#), [3810-1](#), [3810-2](#)

Forming: May be formed into sharp corners with heat

Lengths Available: 50' and 500'

Bend Radius: 3/8"

1/16" I.D. 80A Vinyl Hose

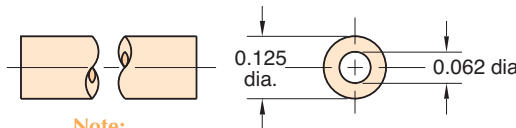

Part No. VYH1-0402-CLT-□

Note:
Consult factory for custom colors

Type: Flexible, durable vinyl plastic hose

Working Range: 0 to 105 psig at 70°F maximum 60 psig at 80°F or above (max. temp. 100°F)

Use With: Hose fittings: [11752-2](#) and clamp [5000-4](#)

Bend Radius: 3x hose dia.

Color: Translucent: Clear

Lengths Available: 50' and 500'

Bend Radius: 3/8"

1/8" I.D. 80A Vinyl Hose

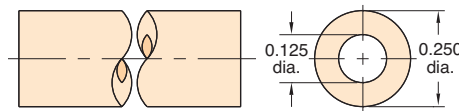

Part No. VYH1-0804-CLT-□

Note:
Consult factory for custom colors

Working Range: 0 to 105 psig at 70°F maximum 60 psig at 80°F or above (max. temp. 100°F)

Use With: Hose fittings: [11752-1](#), [11752-3](#) and [11924](#)
Hose clamps: [5000-2](#)

Bend Radius: 3x hose dia.

Color: Translucent: Clear

Lengths Available: 50' and 500'

Bend Radius: 1/2"

1/8" I.D. Twin Vinyl Hose

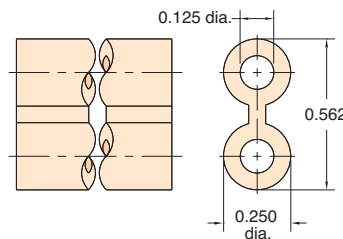

Part No. VYH2-0804-GYS-□

Type: Flexible, durable vinyl plastic hose, but two hoses molded together, one side has rib entire length for identification

Color: Solid: Gray/Gray

Use Clamp: [5000-1](#)

Working Range: 0 to 150 psig at 70°F maximum 60 psig at 80°F or above (max. temp. 100°F)

Use: Ideal for feeding supply in on one line and out on the other, reduces labor; makes neat assembly; may be parted with any sharp cutting edge

Lengths Available: 50' and 500'

Bend Radius: 1/2"